



INSTRUCTION BULLETIN

No. 340800
Machine: 830-II,
Sentinel
Published: 11-2005
Rev. 00

NOTE: DO NOT DISCARD the Parts List from the Instruction Bulletin. Place the Parts List in the appropriate place in the machine manual for future reference. Retaining the Parts List will make it easier to reorder individual parts and will save the cost of ordering an entire kit.

NOTE: Numbers in parenthesis () are reference numbers for parts listed in Bill of Materials.

Installation instructions for **kit number 9001923 and 9001924**

SYNOPSIS:

This kit contains the parts needed to install seat belt kits on 830-II and Sentinel sweepers. Please follow step-by-step instructions.

SPECIAL TOOLS / CONSIDERATIONS: NONE

(Estimated time to complete: 1.5 hours)

Use the instructions below to install both kit 9001923 and 9001924.

PREPARATION:

1. Park the machine on a clean level surface, turn off the machine, remove the key, and set the parking brake.

FOR SAFETY: Before leaving or servicing machine, stop on level surface, set parking brake, turn off machine, and remove key.

2. Disconnect the gas springs (one on each side of the cab) from the back of the cab. The gas springs can remain attached to the doors.
3. Use a small cable tie to tie off the windshield washer hose by the wiper arm.
4. Pry the plastic hole plugs located inside both rear corners of the cab to expose the hardware holding the cab down to the machine. Set the plastic plugs aside. Refer to Fig. 5.

5. Remove the M20 hex nuts and washers holding the cab down to the machine. Set the hex nuts and washers aside. Refer to Fig. 1.

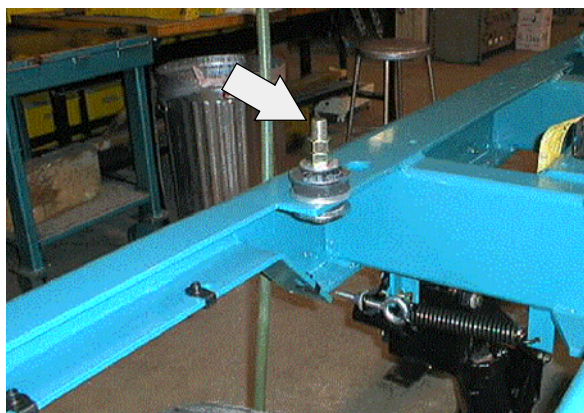

FIG. 1

TILT THE CAB FORWARD

The cab prop arm is located on the passenger side bottom of the cab. Engage the prop arm when the cab is in the forward tilted position. Refer to Fig. 2.

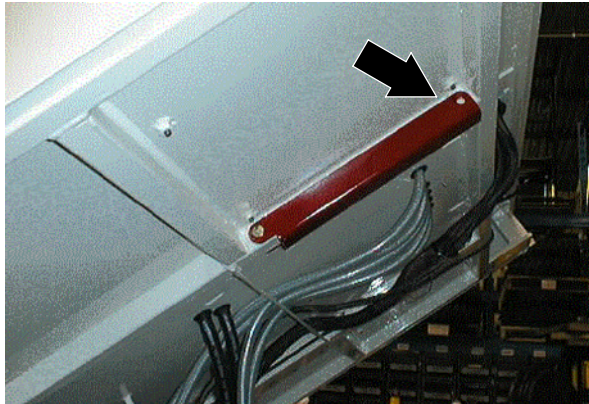

FIG. 2

CAUTION; DO NOT ATTEMPT TO TILT THE CAB WITHOUT AN OVERHEAD MOTORIZED TROLLEY CRANE.

1. Hook the overhead hoist chain to the lug located on the cab. Refer to Fig. 3.

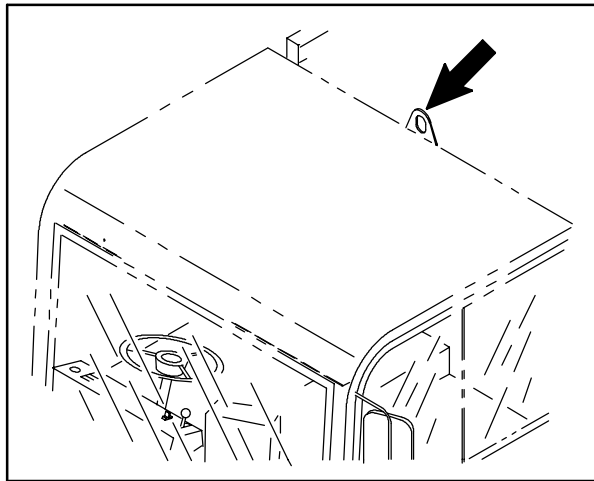

FIG. 3

2. Start lifting the cab and simultaneously moving the hoist toward the front of the machine. The cab is completely tilted when the retaining cable is taut.

3. Pull the pin from the cab prop arm, let arm drop down, install pin into the lower hole on the arm and frame bracket. Refer to Fig. 4.

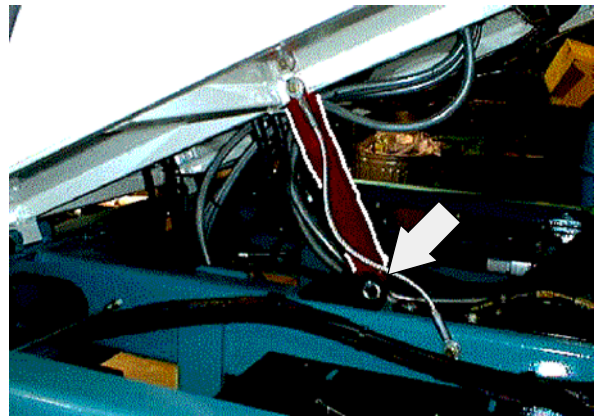

FIG. 4

4. Leave the hoist chain hooked to the cab while working under the cab.

INSTALLATION:

1. Remove the hardware, seat belt retractor, and seat belt bracket from the machine. Set aside all hardware used to mount the seat belt retractor/seat belt bracket to the machine. Discard the seat belt retractor and seat belt bracket. Refer to Fig. 5.

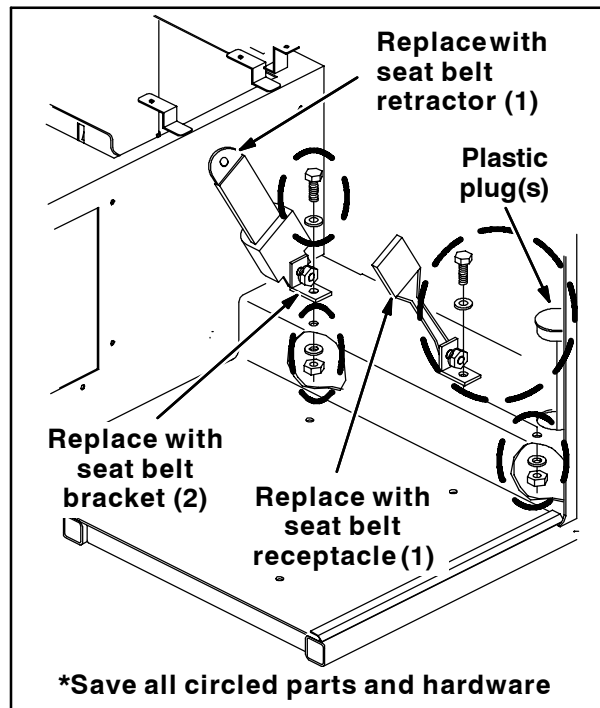

FIG. 5

2. Remove the hardware and seat belt receptacle from the machine. Set the hardware aside. Refer to Fig. 5.

3. Remove the seat belt receptacle from the bracket. Set the bracket and hardware aside. Discard the seat belt receptacle. Refer to Fig. 5.
4. Insert the pin on the new seat belt retractor (1) into the small hole in the seat belt bracket (2) and use two hex screws (3), four flat washers (4), and two hex nuts (5) to attach the seat belt retractor to the seat belt bracket. Refer to Fig. 6.

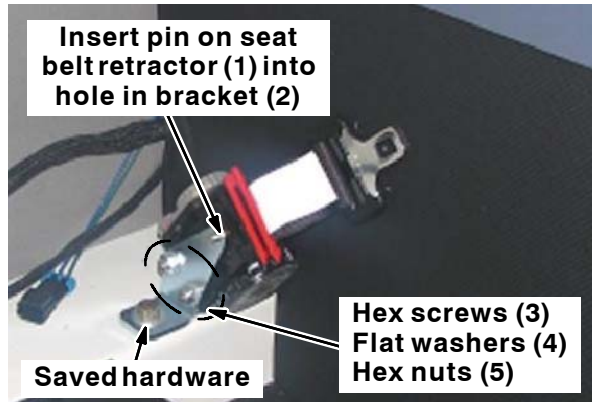

FIG. 6

5. Use the hex nut and washer saved from the previous seat belt retractor/seat belt bracket to attach the new seat belt retractor (1)/seat belt bracket (2) to the machine. Refer to Fig. 5 and Fig. 6.
6. Use the hardware set aside from the previous seat belt receptacle to attach the new seat belt receptacle (1) to the saved bracket. Refer to Fig. 5 and Fig. 7.

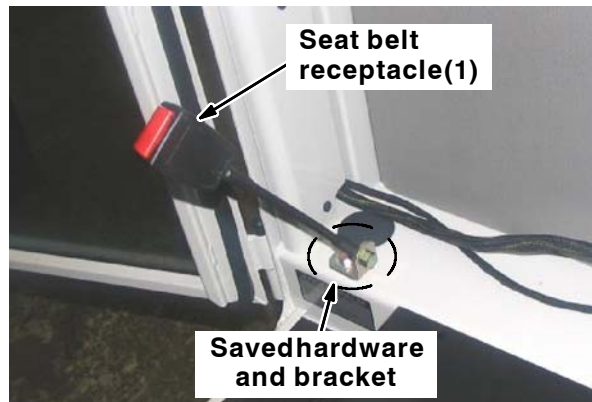

FIG. 7

7. Use the hex nut and washer saved from the previous seat belt receptacle to attach the new seat belt receptacle (1)/seat belt bracket to the machine. Refer to Fig. 5 and Fig. 7.
8. Use the hoist to lower the cab back down onto the frame of the machine.
9. Reinstall the M20 hex nuts and washers to secure the cab. Refer to Fig. 1.
10. Reinstall the plastic plugs into the cab. Refer to Fig. 5.
11. Disconnect the hoist chain from the lug on the center rear of the roof of the cab
12. Cut the small cable tie from the windshield washer hose by the wiper arm.
13. Test the seat belts to ensure they function properly.

Bill of Materials for Seatbelt, RH, Kit, CI-9001923

	Ref.	Tennant Part No.	Description	Qty.
▽		9001923	Seat Belt, RH, Kit, CI	1
▲	1	1028188	Seat Belt, RH	1
▲	2	1028021	Bracket, Seat Belt, RH	1
▲	3	16931	Screw, Hex, M8 X 1.25 X 20, 8.8	2
▲	4	32490	Washer, Flat, 0.25 Std	4
▲	5	08709	Nut, Hex, Lock, M8 X 1.25, NL	2

Bill of Materials for Seatbelt, LH, Kit, CI-9001924

	Ref.	Tennant Part No.	Description	Qty.
▽		9001924	Seat Belt, LH, Kit, CI	1
▲	1	1028186	Seat Belt, LH	1
▲	2	1028112	Bracket, Seat Belt, LH	1
▲	3	16931	Screw, Hex, M8 X 1.25 X 20, 8.8	2
▲	4	32490	Washer, Flat, 0.25 Std	4
▲	5	08709	Nut, Hex, Lock, M8 X 1.25, NL	2

TENNANT COMPANY
P. O. Box 1452
Minneapolis, MN 55440-1452